

1. On-wall installation

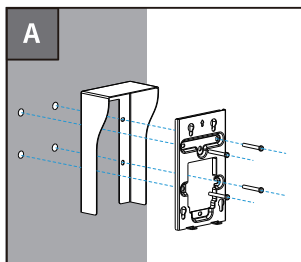

Without embedded box on the wall

Use four **ST4x20 crosshead screws** to secure the **rain cover** and **wall-mounting bracket** to the wall in sequence.

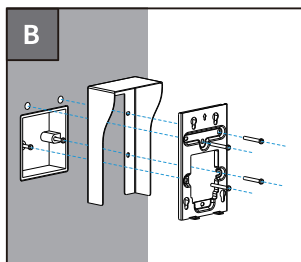

With embedded box on the wall

Use two **ST4x20 crosshead screws** and two **M4x30 crosshead screws** to secure the **rain cover** and **wall-mounting bracket** to the wall in sequence.

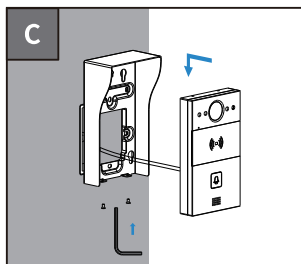

a. After completing the wiring and installing the accessories on the back of the device according to the R20A Quick Guide, insert the four **wall-mounting screws** on the device into the corresponding holes on the wall-mounting bracket.

b. Press down to slide the **wall-mounting screws** into the groove.

c. Use **Allen wrench** to tighten the device with two **M3x6 hex socket screws**.

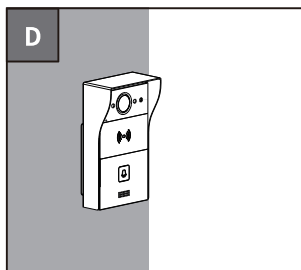

Installation is done.

2. In-wall installation

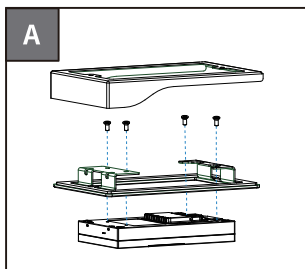

- a. Align the main unit with the slot of the **flush-mounting bracket**, ensuring the device's direction matches the arrow on the bracket.
- b. Secure the main unit to the **flush-mounting bracket** using four **M3x6 crosshead screws**.
- c. Fit the **rain cover** onto the **flush-mounting bracket**.

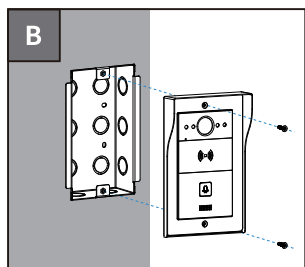

- a. After completing the wiring and installing the accessories on the back of the device according to the R20A Quick Guide, sequentially insert the main unit into the **rain cover** and then into the **flush-mounting box**.
- b. Secure the **flush-mounting bracket** to the **flush-mounting box** using two **M4x15 Torx head screws**.

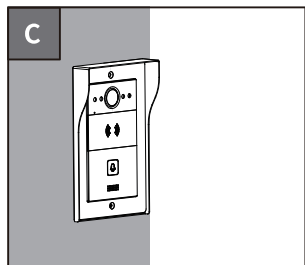

Installation is done.

Notice Information

Information contained in this document is believed to be accurate and reliable at the time of printing. This document is subject to change without notice, any update to this document can be viewed on Akuvox' s website: <http://www.akuvox.com>
© Copyright 2020 Akuvox Ltd. All rights reserved.



AKUVOX (XIAMEN) NETWORKS CO., LTD.
ADD: 10/F, NO.56 GUANRI ROAD, SOFTWARE PARK II, XIAMEN 361009, CHINA
www.akuvox.com