



Installation Guide

For HyPanel



Smarter Home
Sweeter Life

Welcome!

This guide applies to PS51-10VFANCOIL-EU and PS51-24VFANCOIL-EU models of HyPanel.

Contents

Before We Start	2
In the Box	3
Check Compatibility	4
Wiring	7
Installation	13
Get Help	18

Before We Start

Your first time installing this product may take up to 40 minutes.

You'll get faster after each installation.



Warning

The installation procedure involves handling high voltage wiring. Please be careful. To avoid serious personal injury, death, or property damage, turn OFF the power to the circuit and follow all safety precautions before proceeding.

Working with electricity can be dangerous. If you are unsure about, or uncomfortable with the installation, seek the help of a qualified electrician.



Warning

Keep the device and all its parts out of the reach of children. The small parts or accessories contained may be a choking hazard to them.

In The Box

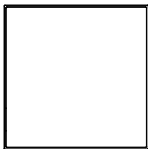

HyPanel x1

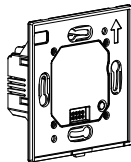

Flush Mounted Module x1



ST3x20mm Phillips Self Tapping
Screw x2



NTC Thermistor x1

Check Compatibility

Product dimensions (mm)

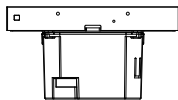

⑤ BOTTOM VIEW

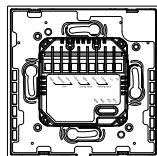

PS51-10VFANCOIL-EU

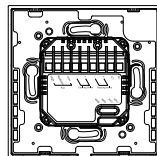

PS51-24VFANCOIL-EU

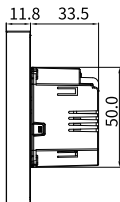

② RIGHT VIEW

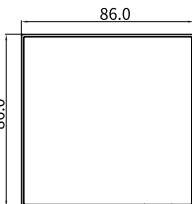

① FRONT VIEW

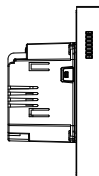

③ LEFT VIEW

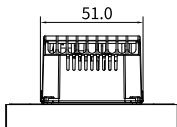

⑥ TOP VIEW

Working space

Make sure HyPanel is compatible with the location where you want to install it.

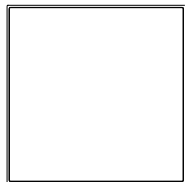

① HYPANEL FRONT VIEW

1100-1600mm TO BOTTOM OF PANEL

ADA Compliance Requirement

GROUND

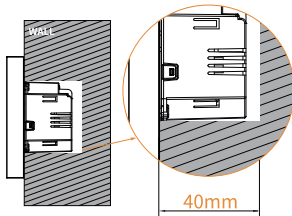
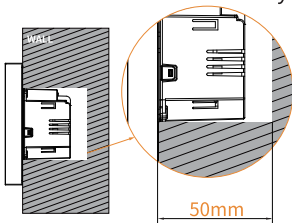

② SIDE VIEW: HYPANEL IN WALL

A 50mm(2 inches) deep electrical box is highly recommended for ease of installation. In some scenarios, especially when the wires can be pushed back into the wall far enough, it may be possible to use a 40mm(1.6 inches) deep box.

Output Load

PS51-10VFANCOIL-EU

- ♦ Fan load capacity: Up to 5A (Resistive), 3A (Inductive)
- ♦ Valve compatibility: 0-10V

PS51-24VFANCOIL-EU

- ♦ Resistive load: 5A at maximum
- ♦ Inductive load: 3A at maximum

24VAC/DC power required

HyPanel operates with either a 24VAC or 24VDC power supply.

Wire sizes for different connections

- ♦ RS485 and NTC: Recommended wire size is 0.14mm^2 - 0.75mm^2 (26-18AWG).
- ♦ Fan and Valve: Maximum wire size should be 1.5mm^2 (16AWG).

Support Wi-Fi connection

HyPanel supports Wi-Fi connectivity on both 2.4GHz and 5GHz frequency bands, complying with the IEEE802.11 b/g/n standards.

Wiring



Warning

Turn OFF the circuit breaker before wiring and proceeding!
Always use a voltage detector to verify the power is OFF
before wiring and installation!

Wiring diagram

PS51-24VFANCOIL-EU

- The 24V- terminal is connected to the negative pole of the power supply.
- The 24V+ terminal is connected to the positive pole of the power supply.
- High/Med/Low wires regulate the fan motor speed.
- Open/Close wires control the cooling or heating valve.
- NTC+ and NTC- terminals are for the thermistor's leads connection. Not required if no thermistor is used.
- 485A and 485B are two signal lines used to connect a third-party device. Not required if no RS485 device is used.

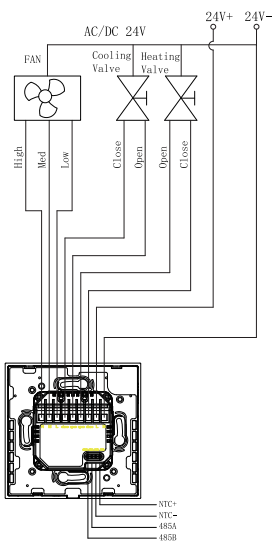

Four Pipe, On/Off

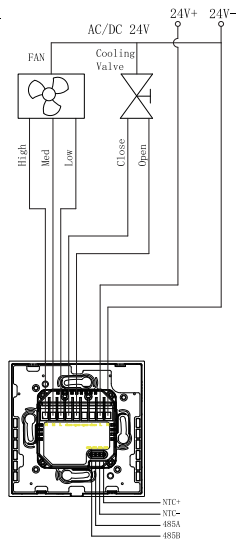

Two Pipe, On/Off

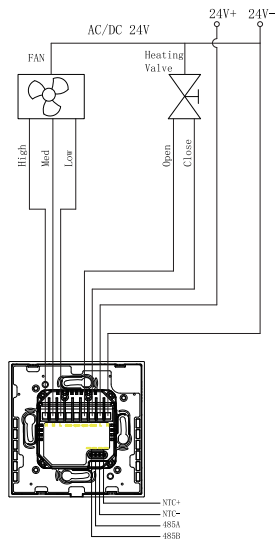

Two Pipe, On/Off

PS51-10VFANCOIL-EU

- ♦ The 24V- terminal is connected to the negative pole of the power supply.
- ♦ The 24V+ terminal is connected to the positive pole of the power supply.
- ♦ High/Med/Low wires regulate the fan motor speed.
- ♦ CV+/CV- wires control the cooling valve.
- ♦ HV+/HV- wires control the heating valve.
- ♦ NTC+ and NTC- terminals are for the thermistor' s leads connection. Not required if no thermistor is used.
- ♦ 485A and 485B are two signal lines used to connect a third-party device. Not required if no RS485 device is used.

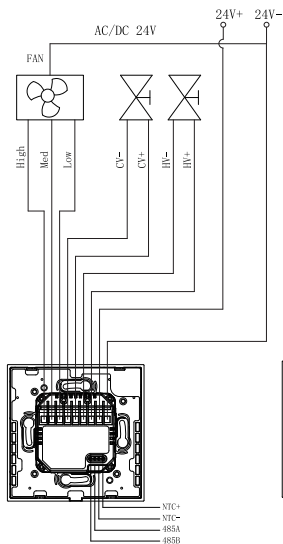

Four Pipe, On/Off

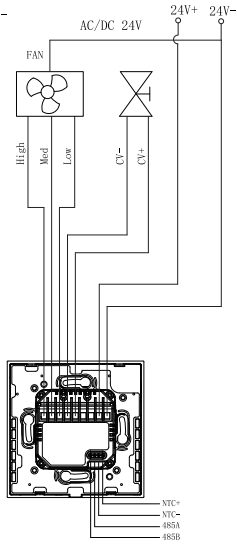

Two Pipe, On/Off

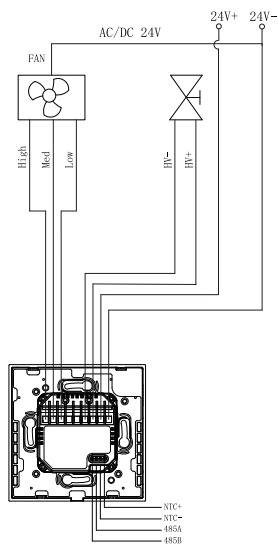

Two Pipe, On/Off

Connect wires

- 1 Strip and straighten wires



Wires connected to HyPanel should have stripped and straight ends. Remove the plastic sheathing of the wire, and make sure the exposed wire ends measure approximately 8 mm (5/16 inch) in length.

- 2 Connect all wires

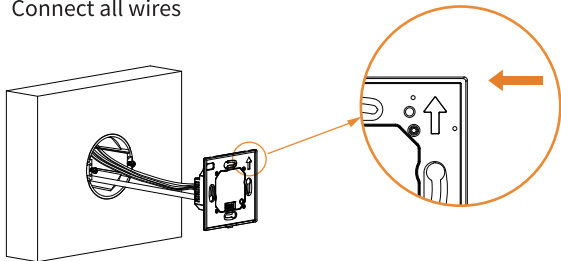

Always make sure the arrow on the front of the flush mounted module is pointing up.

PS51-10VFANCOIL-EU

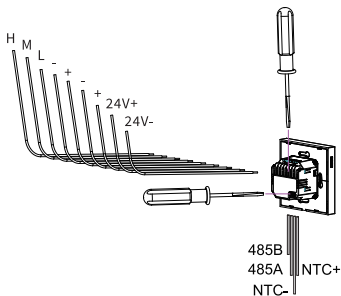

PS51-24VFANCOIL-EU

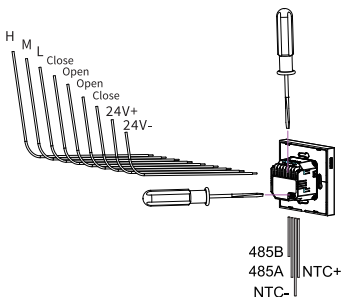

- Plug the wires to the corresponding terminals on the back of the flush mounted module.
- Tighten the screws clockwise with a flat-head screwdriver until wires are secure.
- Double check by gently tugging on each wire.
- To use a thermistor, plug the NTC cable into the designated terminals at the bottom right.
- To connect to a RS485 device, connect the RS485 cables to the designated terminals.

Installation

1 Insert screws

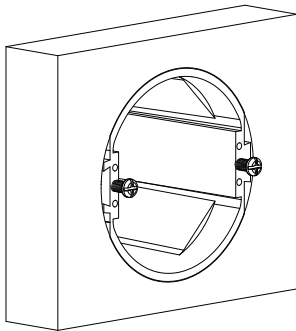

- Insert the supplied screws into the designated holes on the electrical box.
- Change the torque on the electric screwdriver to 5kgf.cm.
- Turn screws clockwise with the screwdriver.
- Do not fully tighten the screws. The screw head must protrude at least 3 mm (1/8 inch) from the wall surface.

2 Install flush mounted module

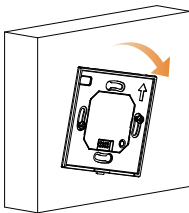

Attach the flush mounted module to the electrical box. The screws should go through the holes on the module.

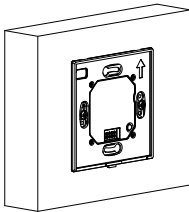

- Adjust the module to be level and ensure it is flush against the wall.
- Tighten the screws to attach the module to the wall, taking care not to over-tighten them.

3 Test connected devices

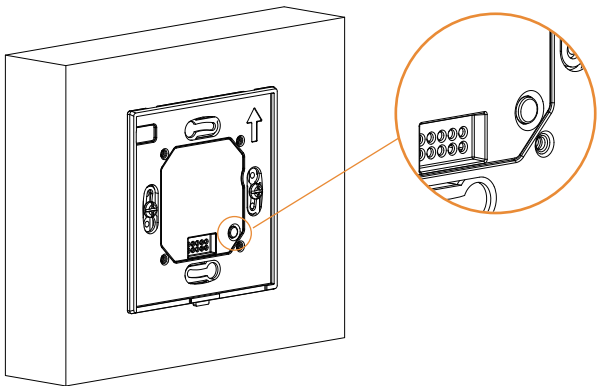

- Turn on the circuit breaker to provide power to the flush mounted module.
- Press the button on the module to check if the connected devices can work.

If the devices cannot function, do NOT install the panel. Turn the power off and re-check the wire connections.

4 Install panel

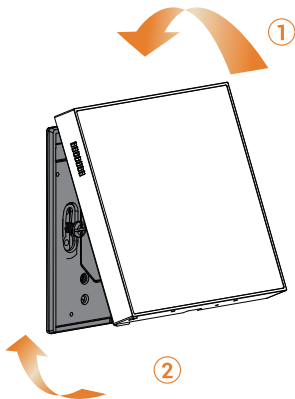

- Position the panel at a tilt as the picture shows.
- Press the panel into the flush mounted module until it clicks.

If you need to remove the panel

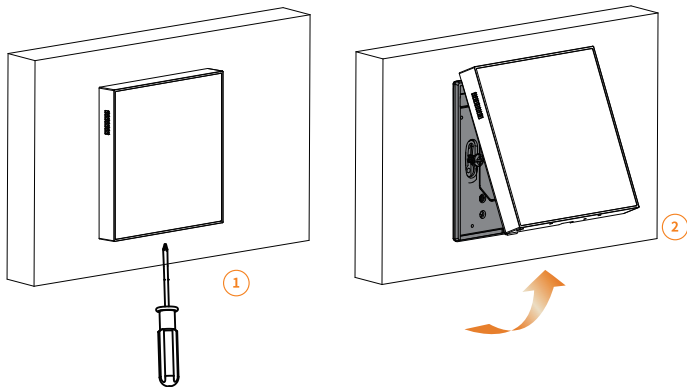

- Insert a flat-head screwdriver with about 6mm width into the slot at the bottom edge.
- Gently pry the panel up.

Congratulations!

You are done with the HyPanel installation!

Start your smart home journey with Akubela now!

Get Help

For help or more assistance,
contact us at: <https://ticket.akuvox.com/>

For videos, guides, and additional product formation,
visit us at: <https://knowledge.akuvox.com>

